

# Ratchet lever hoist model Silverline HZ S



Capacity 750 - 6000 kg

The Silverline HZS is designed and built for safe and efficient operation.

A hoist with low maintenance - at an economical price.

## Features

- Strong bolts between side plates and housing cover ensure increased stability.
- Chain guide rollers eliminate fouling and jamming of chain.
- Bearings for side plates permit a long service life.
- Zinc-plated load chain as standard.
- Drop forged suspension and load hooks are made from high tensile steel and fitted with safety latches.



**This hoist is not designed for passenger elevation applications and must not be used for this purpose.**

## Technical data

Model	EAN-No. 4053981*	Capacity in kg/ number of chain falls	Chain dimensions d x p mm	Lift with one full lever turn mm	Handle pull at WLL daN	Weight at standard lift (3 m) kg
<b>HZS 750</b>	*889290	750/1	6 x 18	20	20	7.0
<b>HZS 1500</b>	*889306	1500/1	8 x 24	10	36	10.0
<b>HZS 3000</b>	*889320	3000/1	10 x 30	17	38	18.0
<b>HZS 6000</b>	*889313	6000/2	10 x 30	9	39	27.0

## Dimensions in mm

Model	HZS 750	HZS 1500	HZS 3000	HZS 6000
A min.	330	410	490	640
B	24	30	45	55
C	26	31	34	46
D	14	18	26	37
E	280	410	410	410
F	111	175	190	240
G	33	50	60	80
H	78	125	130	160
J	142	180	195	200
K	55	75	85	90
L	87	105	110	110

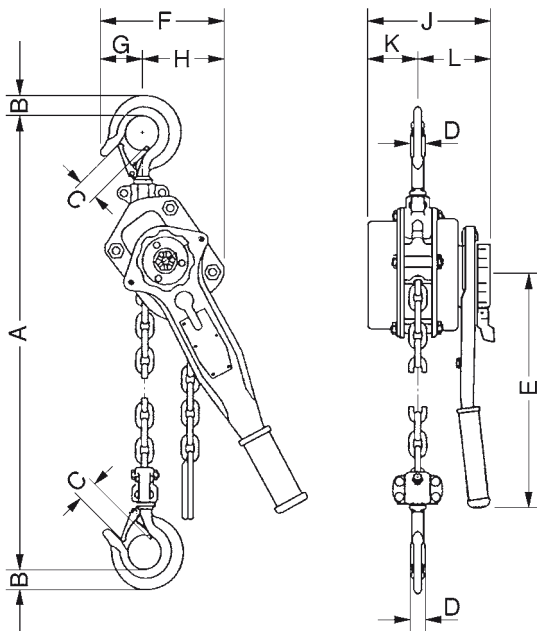

**Model Silverline HZS**  
500 - 2000 kg, single fall